

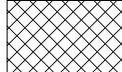

KEYNOTES

NOTES

-  AVAILABLE STAGING AND STORAGE AREAS FOR GENERAL CONTRACTOR (GC). NO OTHER AREAS ARE AVAILABLE AND GC MUST CONFINe HIS/ HER WORK TO THE INDICATED AREAS
-  MAINTAIN 20'-0" FIRE ACCESS LANE DURING CONSTRUCTION. FOR NEW PERMANENT FIRE ACCESS LANE, REFER TO G1.2 - FIRE ACCESS SITE PLAN
-  FENCED AREA
- NOTE:
1. FOR STAGING AREA, REFER TO RF-2

Key Plan

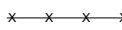
| | |
|-----------------|---|
| Consultant Seal | Agency Approval FILE NO.37-C1 IDENTIFICATION STAMP DIV. OF THE STATE ARCHITECT APPL. 04-115420 ACS _____ FLS _____ SSS _____ DATE _____ |
|-----------------|---|

Project Title

PALOMAR COLLEGE
Learning for Success

PALOMAR COLLEGE
NEW STORAGE BUILDINGS
1140 W. MISSION RD.,
SAN MARCOS, CA 92069
(760) 744-1150

| No. | Description | Date |
|-----|-------------|------|
| | | |
| | | |
| | | |
| | | |

Drawing Title
FOR REFERENCE ONLY - SITE PLAN

| | | |
|------------------|-------------------|-------------------------|
| Architect's Seal | Designed/Designer | Project No. 3443001-302 |
| | Drawn: Author | Scale: 1" = 20'-0" |
| | QA/QC Checker | Drawing No. RF-1 |
| | Date: 10/18/17 | |

OVERALL SITE PLAN 1
1" = 20'-0"

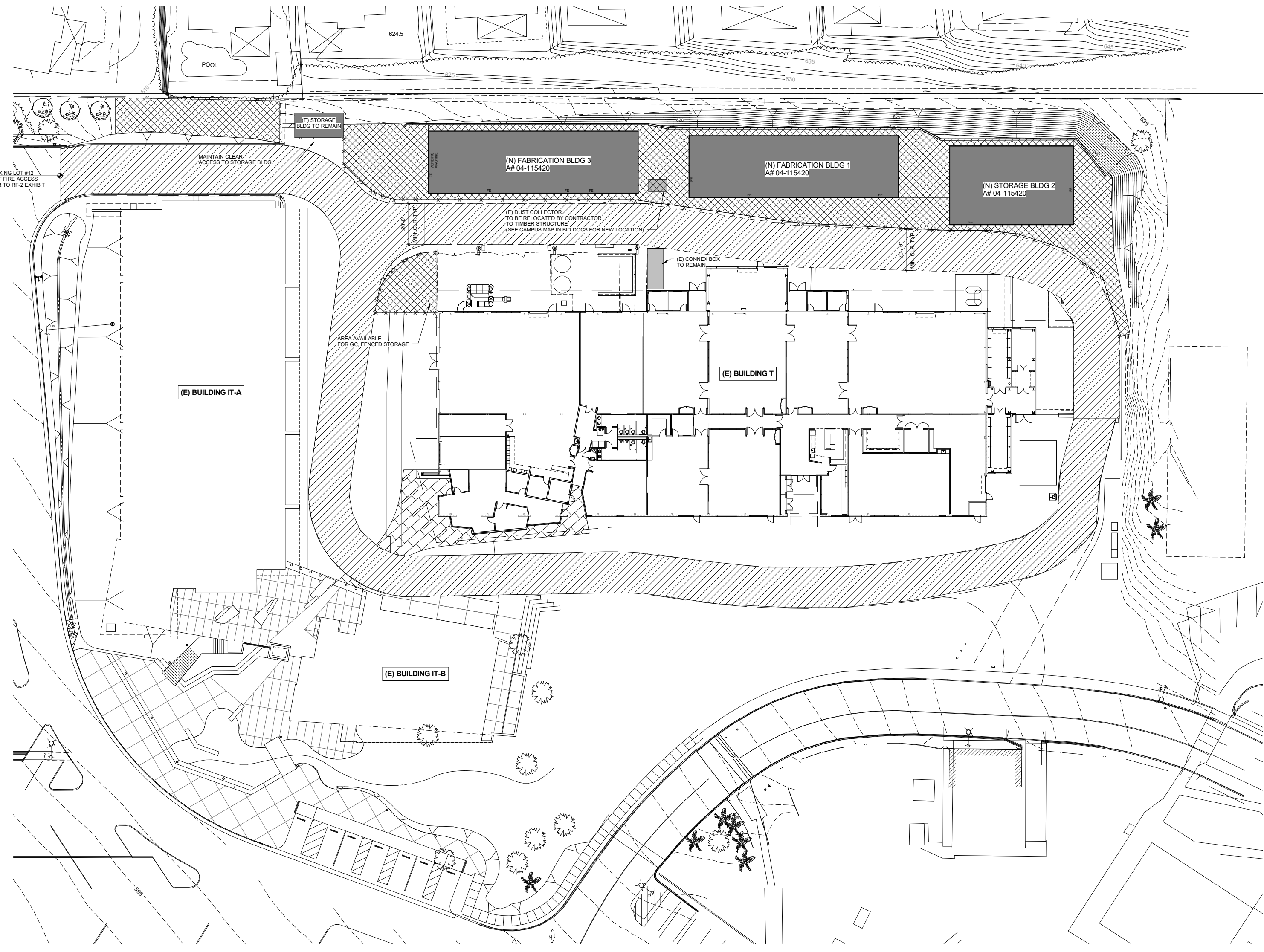
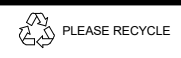

C:\Revit Local Files\3443001-A15_Central_gsandoval.rvt